

Technical Meeting for Special Surveys and National Accounts of the International Comparison Program

Rental

Bruno Lana
Statistics Division
ECLAC



Rental Form

- ▶ For the Cycle 2017, only 13 items are considered in the basic heading. They are classified into 5 types of dwellings, and differ in size (square meters / square feet)
 - ▶ Single-family House
 - ▶ Attached House / Row House
 - ▶ Studio Apartment
 - ▶ One bedroom Apartment
 - ▶ Two bedrooms Apartment

Single Family House



Single-family House	120-180 m ²	1300-1950 ft ²
Single-family House	180-240 m ²	1950-2600 ft ²
Single-family House	240-360 m ²	2600-3900 ft ²
Single-family House	360-460 m ²	3900-5000 ft ²



Attached House / Row House



Attached House / Row House 80-120 m² 850-1300 ft²

Attached House / Row House 120-180 m² 1300-1950 ft²

Attached House / Row House 180-240 m² 1950-2600 ft²



Studio Apartment



Studio Apartment 15-35 m² 160-380 ft²

Studio Apartment 35-60 m² 380-650 ft²



One-bedroom apartment

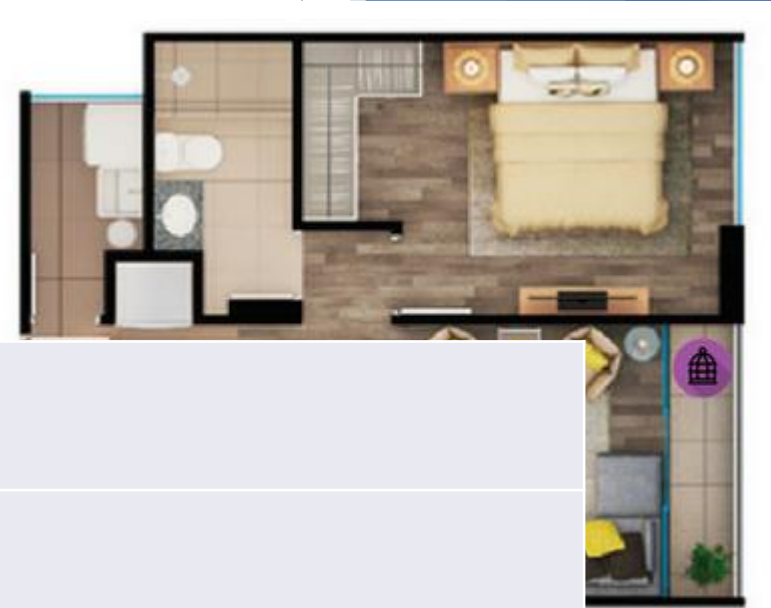
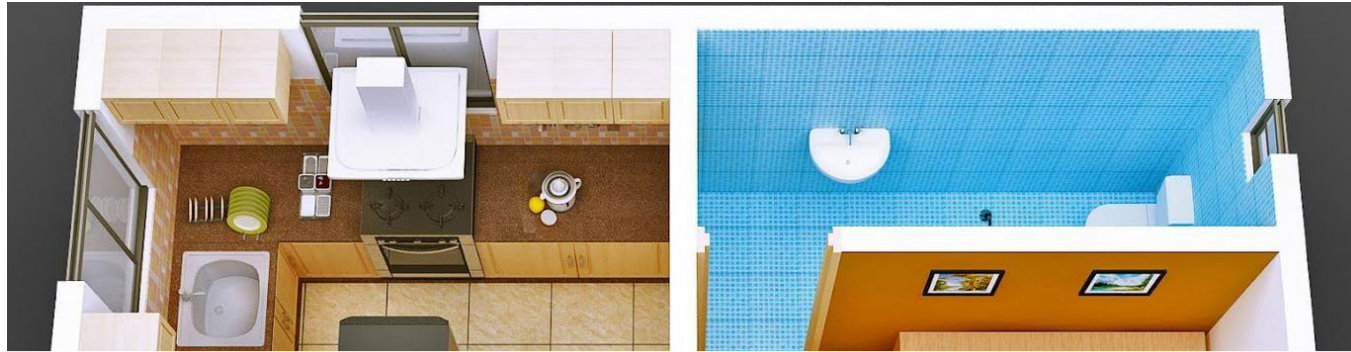

One-bedroom Apartment 40-60 m² 430-650 ft²

One-bedroom Apartment 60-80 m² 650-850 ft²



Two-bedrooms apartment

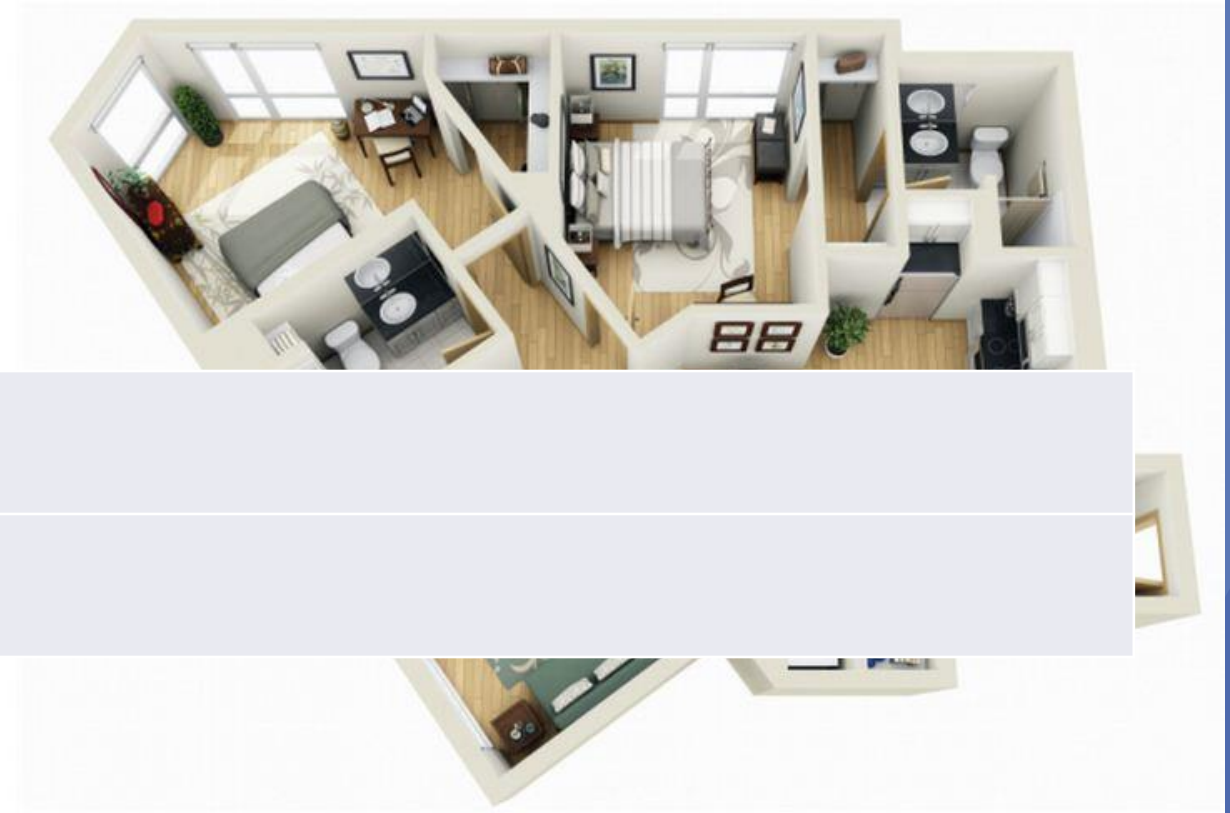

Two-bedrooms Apartment 60-80 m² 540-850 ft²

Two-bedrooms Apartment 80-120 m² 850-1300 ft²



Data Submission Form

BH Name	Actual rentals for housing
BH Code	1104111

Type of housing

Item Code	1104111101
Item Name	Single-detached house, 120-180 m ²
Number of units	1
Unit of measurement	Annual rent (national average)
Dwelling size (usable surface) in m ²	120-180
Dwelling size (usable surface) in approximate sqft	1300-1950
Dwelling facilities include	Electricity line; inside water (cold and hot); private toilet with water; private kitchen
Rent excludes	Furniture; materials and services for maintenance; energy supply (such as water, electricity, gas and other fuels); subsidies from government or employers
Specify	Dwelling size; Annual rent per m ²

DATA ENTRY	Example	1104111101
		Single-detached house, 120-180 m ²
Annual rent	20.000	
Dwelling Size (usable surface) in m ²	150	
Annual rent per m ²	133	

Annual Average price of rental

Price per m2

Average size in m²
(convert ft2 to m2)

Guidelines - Rental

- ▶ Collect average annual price for each type of dwelling
- ▶ Estimate average size of the type of dwelling
- ▶ Inform the period of data collection
- ▶ Provide national CPI detail (or other index) to repropagate prices to 2017
- ▶ **Read the instructions on the form** before inserting the data.

Sources

▶ CPI item

110000	INDIVIDUAL CONSUMPTION EXPENDITURE BY HOUSEHOLDS
110100	FOOD AND NON-ALCOHOLIC BEVERAGES
110200	ALCOHOL BEVERAGES, TOBACCO AND NARCOTICS
110300	CLOTHING AND FOOTWEAR
110400	HOUSING , WATER, ELECTRICITY, GAS, AND OTHER FUELS
110500	FURNISHING, HOUSEHOLD EQUIPMENT AND ROUTINE MAINTENANCE OF THE HOUSE
110600	HEALTH
110700	TRANSPORT
110800	COMMUNICATION
110900	RECREATION AND CULTURE
111000	EDUCATION
111100	RESTAURANTS AND HOTELS
111200	MISCELLANEOUS GOODS AND SERVICES

► Rental Websites



The screenshot shows the VivaReal website interface. At the top, there is a blue navigation bar with 'MENU', the VivaReal logo, and 'ENTRAR'. Below this, there are three tabs: 'COMPRAR', 'ALUGAR' (which is selected), and 'IMÓVEIS NOVOS'. The main content area displays '161.979 Apartamentos para alugar em São Paulo - SP'. There are two filter tags: 'São Paulo - SP' and 'Apartamento'. Below the filters is a button labeled 'EDITAR FILTROS'. A dropdown menu for 'Ordenar por' is visible. The first listing is for an apartment in São Paulo, with a price of R\$ 2.900 and a button for 'DETALHES'.

MENU VivaReal ENTRAR

COMPRAR ALUGAR IMÓVEIS NOVOS

161.979 Apartamentos para alugar em São Paulo - SP

São Paulo - SP x Apartamento x

EDITAR FILTROS

Ordenar por

Rua Bela Cintra - Consolação, São Paulo - SP
Apartamento com Quarto para Alugu...
50 m² 1 Quarto 1 Banheiro 1 Vaga

Oportunidade. Apartamento situado no melhor condomínio da Rua Bela Cintra, absolutamente completo e praticamente

R\$ 2.900 **DETALHES** CONTATAR MAPA
Condomínio: R\$ 553

► Rental Surveys

Technical Meeting for Special Surveys and National Accounts of the International Comparison Program

Rental

Bruno Lana
Statistics Division
ECLAC

